

HSE ROHS

SPECIFICATIONS

Rated Current: 3.0AMP
 Contact Resistance: 20mΩ Max
 Withstand Voltage: 1000V AC/DC
 Insulation Resistance: 1000MΩ Min
 Operation Temperature: -40°c to +105°c

Contact Material: Brass
 Contact Plating: Au or Sn Over Ni
 Insulator Material: Polyester(UL94V-0)
 Standard: PA66
 Max.Processing Temp: 180°C for 30-60 seconds
 (200°C for 10 seconds)

Recommended P.C.B Layout(Top Side)
 (PCB BOARD TOLERANCE±0.05)

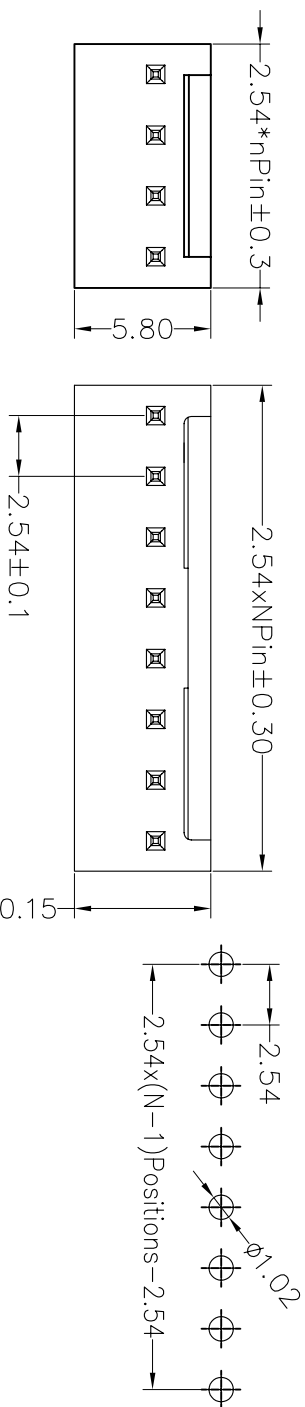

Ordering Information

JL 2541 S - XX D XX X 01

No. of Pins Per Row 2~20P
 Insulator Material Option
 C=BK-PA6T D=BK-PA66
 Contact Plating
 G0:Gold Flash S0:Gold Flash/Tin SN:Tin SM:Matte-Tin
 Color
 W=White E=Beige

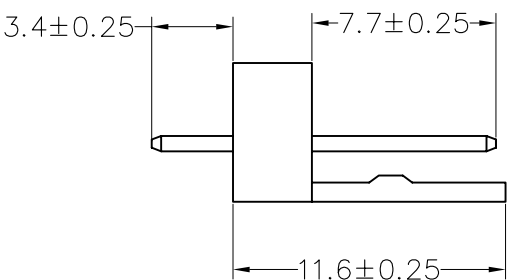
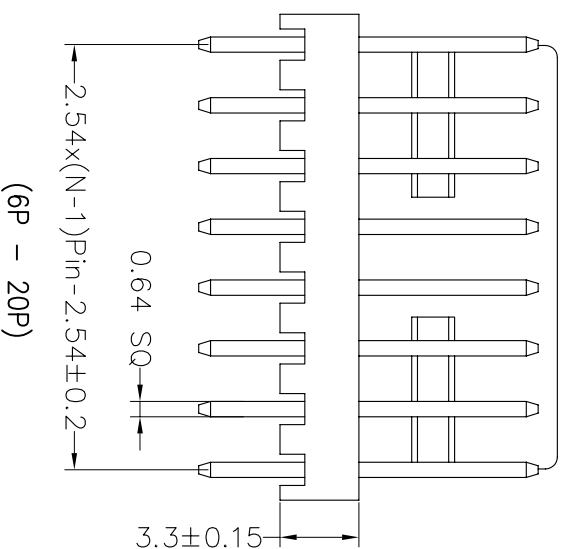
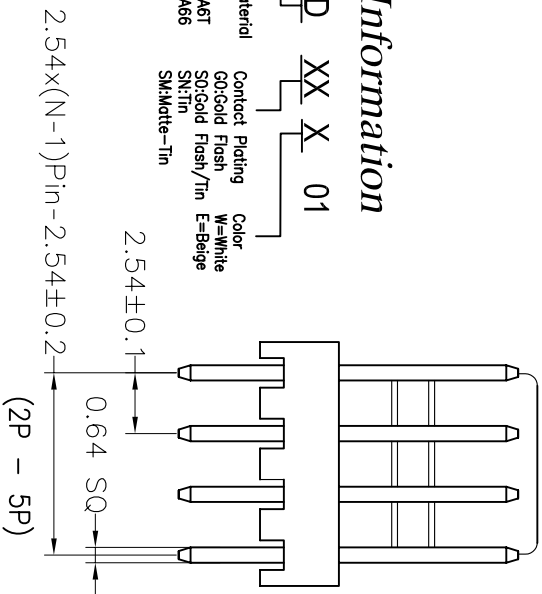

OPERATION

X.X ±0.30

X.XX ±0.20

X.XXX ±0.10

Angle ±3°

DIM TOL

DRAW

BEN

12.05.22

CHECK

APPROVE

SCALE

UNIT mm

FIT A4

SIZE A4

SHEET 1/1

PROJ.

JILIN 深圳市锦凌电子有限公司
 SHENZHEN JINLING ELECTRONIC CO.,LTD
 Tel: 86-755-2997-5806/5802 Fax: 86-755-2997-5992

PART NO. JL2541S-XXDXE01

TITLE: 2.54 Wafer Npin 180°

| REV | DATE | MODIFICATION DESCRIPTION | CHANGE |
|-----|------------|--------------------------|--------|
| A0 | 2012.05.22 | NEW DRAWING | |
| 1 | | | |